

## Datasheet - AZ 15/16-B6

Safety switch with separate actuator / AZ 15 / Actuator AZ 15



Preferred typ



• For very small actuating radii in line with or at 90° to the plane of the actuator

(Minor differences between the printed image and the original product may exist!)

### Ordering details

Product type description	AZ 15/16-B6
Article number	101137434
Strobe lamp	4030661104706
eCl@ss	27-27-92-16

### Global Properties

Permanent light	Beweglicher Betätiger AZ 15/16-B6
Weight	20

### Mechanical data

Design of actuators	angled, flexible
Minimum actuating radius	35

### notice

Actuating radius adjustable using an hexagonal key wrench 2,5 mm (a/b) mm A/F (a and b), minimum 35 mm at 90° to the plane of the actuator and minimum 38 mm, in line with the plane of the actuator

The axis of the hinge should be 11 mm above the top edge of the safety switch and in the same plane

### Documents

**Operating instructions and Declaration of conformity (fi)** 101 kB, 02.07.2015

Code: mrl\_az15-16-betaetiger\_fi

**Operating instructions and Declaration of conformity (es)** 115 kB, 12.02.2014

Code: mrl\_az15-16-betaetiger\_es

**Operating instructions and Declaration of conformity (it)** 114 kB, 10.02.2014

Code: mrl\_az15-16-betaetiger\_it

**Operating instructions and Declaration of conformity (de)** 296 kB, 30.01.2014

Code: mrl\_az15-16-betaetiger\_de

**Operating instructions and Declaration of conformity (cn)** 137 kB, 30.06.2015

Code: mrl\_az15-16-betaetiger\_cn

**Operating instructions and Declaration of conformity (nl)** 114 kB, 11.03.2014

Code: mrl\_az15-16-betaetiger\_nl

**Operating instructions and Declaration of conformity (pt)** 115 kB, 23.05.2014

Code: mrl\_az15-16-betaetiger\_pt

**Operating instructions and Declaration of conformity (jp)** 165 kB, 11.08.2014

Code: mrl\_az15-16-betaetiger\_jp

**Operating instructions and Declaration of conformity (en)** 114 kB, 24.02.2014

Code: mrl\_az15-16-betaetiger\_en

**Operating instructions and Declaration of conformity (pl)** 155 kB, 11.03.2014

Code: mrl\_az15-16-betaetiger\_pl

**Operating instructions and Declaration of conformity (fr)** 114 kB, 14.04.2014

Code: mrl\_az15-16-betaetiger\_fr

**Operating instructions and Declaration of conformity (sv)** 113 kB, 17.06.2015

Code: mrl\_az15-16-betaetiger\_sv

## Images

---

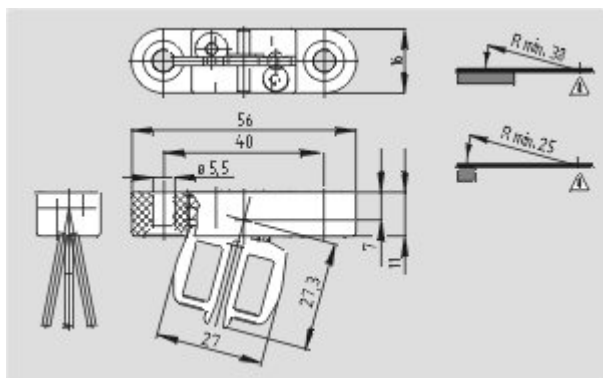

Dimensional drawing (actuator)

---

K.A. Schmersal GmbH & Co. KG, Möddinghofe 30, D-42279 Wuppertal

The data and values have been checked thoroughly. Technical modifications and errors excepted.

Generiert am 08.02.2018 - 15:14:47h Kasbase 3.3.0.F.64I